



Technical Information Marcelle Theater

Dimensions

| <u>Area</u> | <u>Width</u> | <u>Length</u> | <u>Height</u> |
|-------------------------------------|--------------|---------------|---------------|
| Entire Room | 35'10" | 49'3" | 16'0' |
| Performance Space with Base Seating | 35'10" | 30'3" | - |
| Lighting Grid | - | - | 13'7" |

Seating

The Marcelle Theater features risers and chairs, which allow for customizable seating setups.

| <u>Seating Setup</u> | <u>House Capacity</u> |
|----------------------|-----------------------|
| Base Setup* | 100 |
| Max Capacity | 150 |

*"Base Setup" refers to the configurations of risers and seats shown in the provided ground plan. Renters are permitted to alter the seating configuration, with the understanding that they are required to return the seating to its "Base Setup" before relinquishing possession of the space.

| <u>Item</u> | <u>Quantity</u> |
|--------------------------------------|-----------------|
| 4' L x 3'D x 8" H Seating Risers | 2 |
| 4' L x 3'D x 16" H Seating Risers | 1 |
| 4' L x 3'D x 24" H Seating Risers | 1 |
| 8' L x 3'D x 8" H Seating Risers | 10 |



KRANZBERG ARTS
FOUNDATION



THE MARCELLE
HOME FOR THE ARTS

Kranzberg Arts Foundation
3224 Locust St. Suite 401
St. Louis, MO 63103
info@kranzbergartsfoundation.org
(314) 533-0367

| | |
|--------------------------------------|-----|
| 8' L x 3'D x 16" H Seating Risers | 7 |
| 8' L x 3'D x 24" H Seating Risers | 7 |
| 8' L x 3'D x 32" H Seating Risers | 7 |
| Riser Guard Rails | 30 |
| Theater Seats | 135 |

Lighting

| <u>Instruments</u> | <u>Quantity</u> |
|-------------------------------|-----------------|
| 6" Fresnel | 10 |
| Source Four Ellipsoidal Zooms | 20 |
| ETC Source Four Parnel | 10 |
| Chauvet LED Slim Pars | 8 |
| Par 38 (House Lights) | 12 |

| <u>Controls/Dimming</u> | <u>Quantity</u> |
|---|-----------------|
| ETC Element Light Board | 1 |
| LED Backlit Monitors | 2 |
| ETC Smart Bar 2 4-Channel DMX Controlled | 8 |
| ETC Smart Bar 2 6-Channel DMX Controlled | 2 |



| <u>Frames</u> | <u>Quantity</u> |
|--|-----------------|
| 6" Fresnel Gel Frame | 10 |
| Source Four Ellipsoidal Zoom Gel Frame | 20 |
| ETC Source Four Parnel Gel Frames | 10 |
| Chauvet LED Slim Par Gel Holders | 8 |

| <u>DMX Cables</u> | <u>Quantity</u> |
|-------------------|-----------------|
| 10' 5-Pin DMX | 5 |

| <u>Power Cables and Accessories</u> | <u>Quantity</u> |
|-------------------------------------|-----------------|
| 10' Edison Extension | 2 |
| 15' Edison Extension | 2 |
| 15' Edison Extension with 3 Outputs | 3 |

Audio

| <u>Speakers and Mixing Equipment</u> | <u>Quantity</u> |
|--------------------------------------|-----------------|
| Midas M32 Digital Mixing Console | 1 |
| JBL AM 7212/95DP House Speakers | 3 |
| Rapo-Horizon 16x4 snake system | 1 |
| Direct Box | 2 |
| RCA to 1/8 Cable | 1 |

| <u>Microphones</u> | <u>Quantity</u> |
|--------------------------------|-----------------|
| SM 58 | 3 |
| SM 57 | 2 |
| BETA 98 A/C Instrument Mic | 2 |
| C451B Condenser Instrument Mic | 2 |
| QLX Wireless Body Mic Pack | 4 |
| Receivers for QLX Body Mics | 4 |



KRANZBERG ARTS
FOUNDATION



THE MARCELLE
HOME FOR THE ARTS

Kranzberg Arts Foundation
3224 Locust St. Suite 401
St. Louis, MO 63103
info@kranzbergartsfoundation.org
(314) 533-0367

| | |
|---------------------------------|---|
| Head Worn Mic for QLX Body Mics | 5 |
|---------------------------------|---|

| <u>Stands</u> | <u>Quantity</u> |
|----------------------|-----------------|
| 2-Section Boom Stand | 6 |

| <u>Cables</u> | <u>Quantity</u> |
|---------------|-----------------|
| 15' XLR | 10 |
| 25' XLR | 10 |
| 50' XLR | 6 |

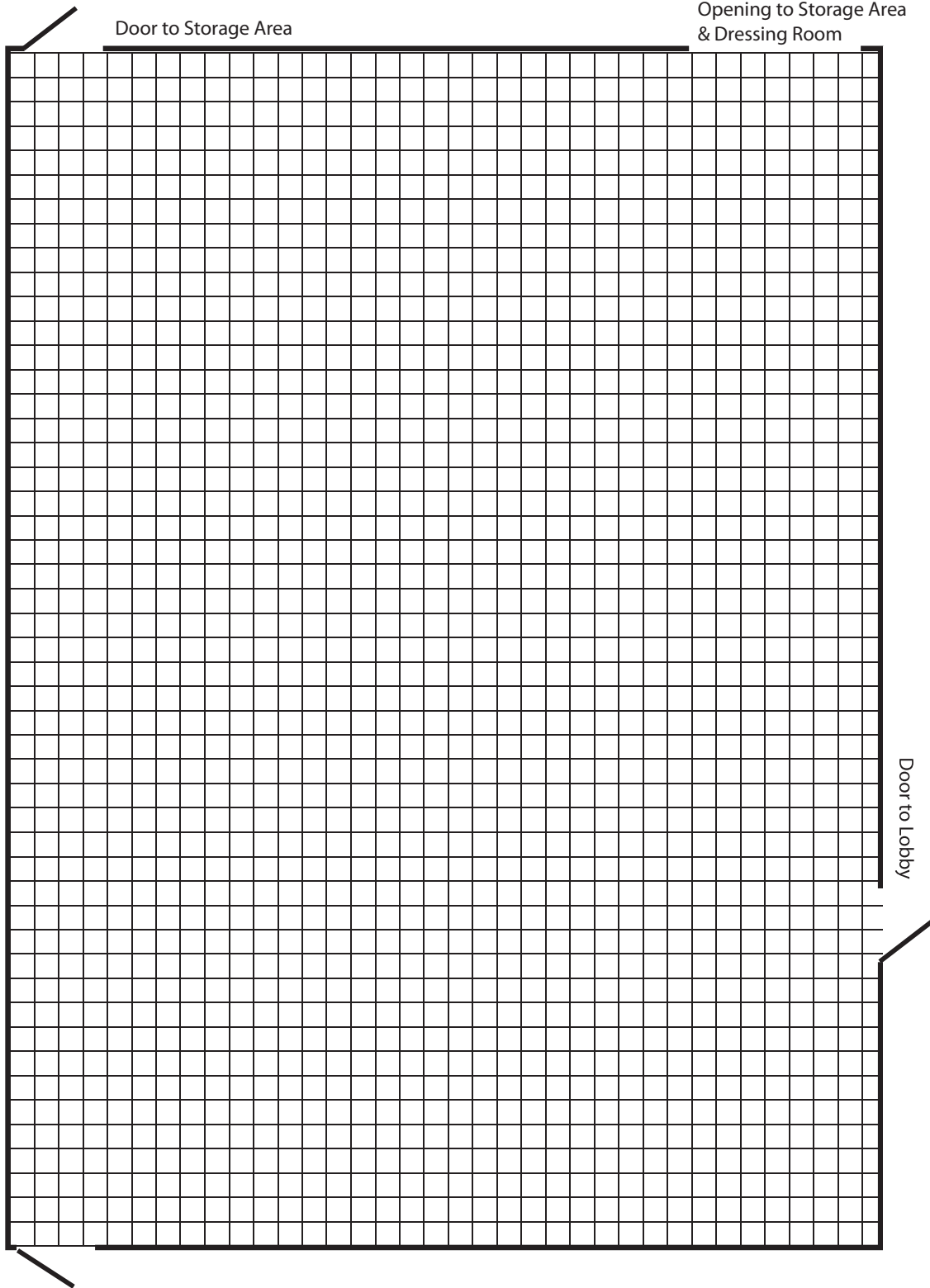

Door to
Dance Studio

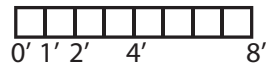

Scale in Feet



KRANZBERG ARTS
FOUNDATION



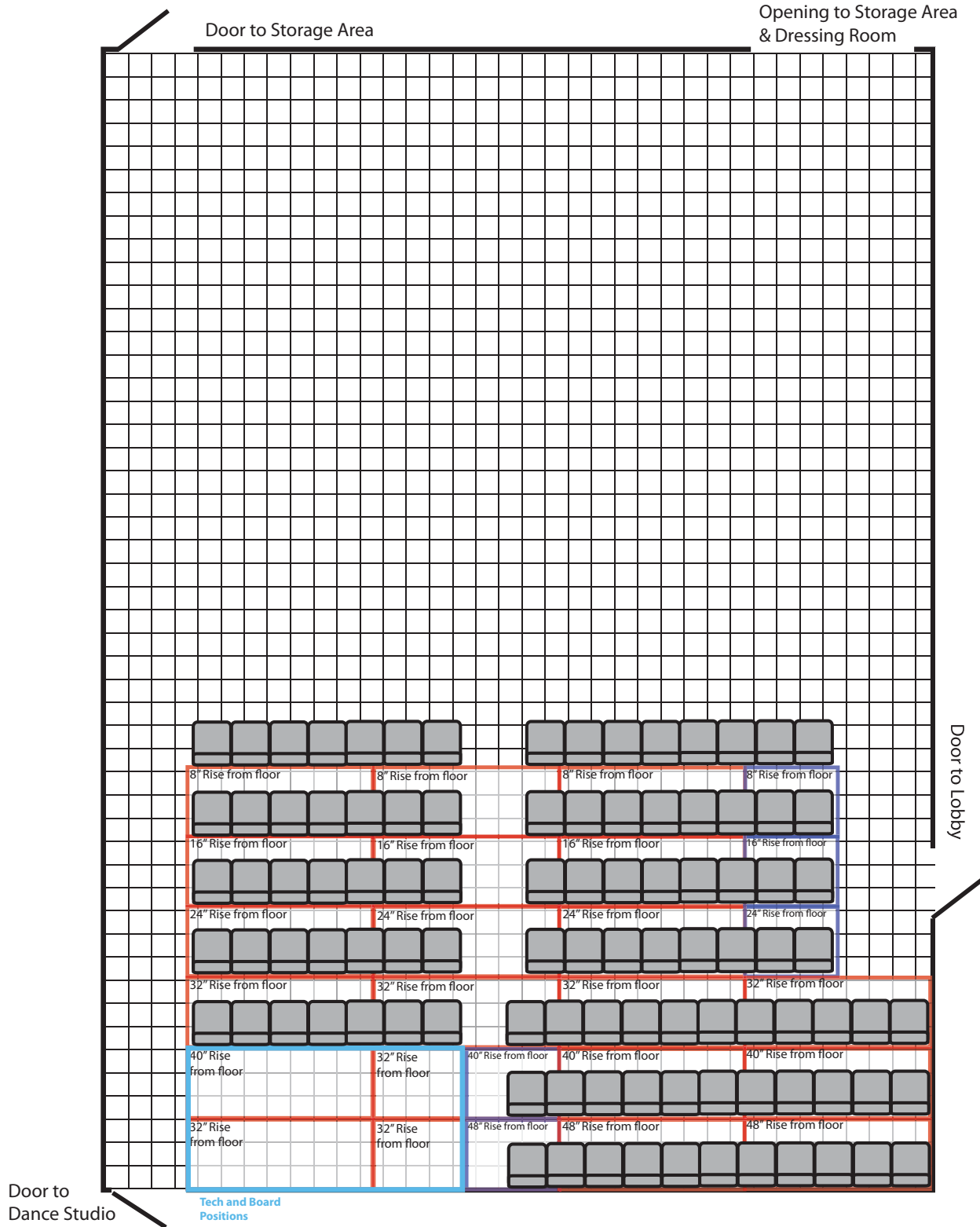

THE MARCELLE
HOME FOR THE ARTS

The Marcelle Theater Ground Plan Base Seating Configuration



KEY

 8' x 3' Seating Riser

 4' x 3' Seating Riser

 Theater Seat

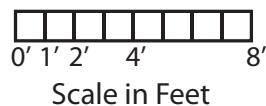

As of 12/27/16
Developed by Keller Ryan
Kranzberg Arts Foundation Production Manager
keller@kranzbergartsfoundation.org

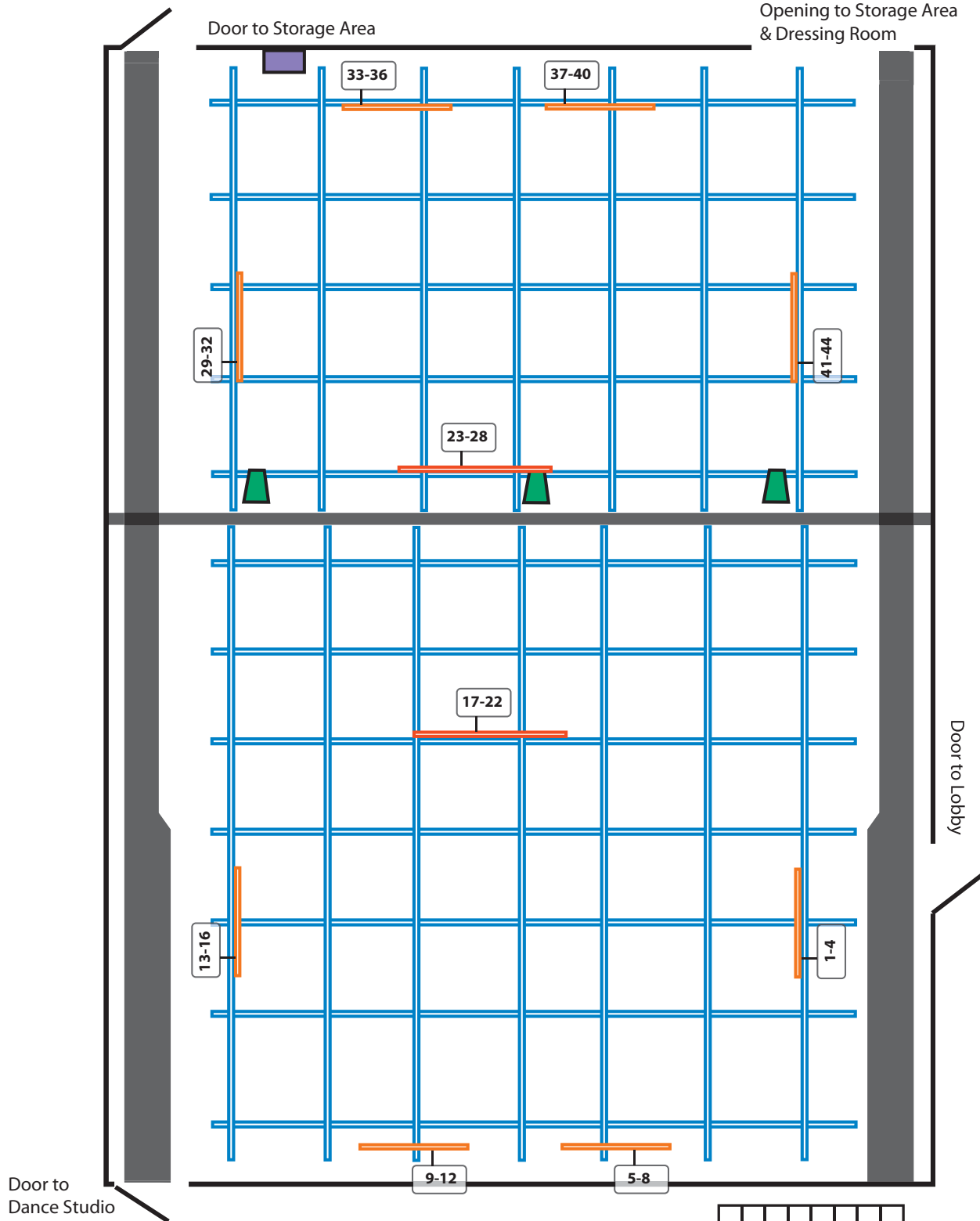

KEY

| | | | |
|--|------------------------|--|------------------------|
| | Grid Pipe | | Snake System Input Box |
| | 4-Channel ETC Smartbar | | House Speaker |
| | Channel # Range | | |
| | 6-Channel ETC Smartbar | | |

0' 1' 2' 4' 8'
Scale in Feet

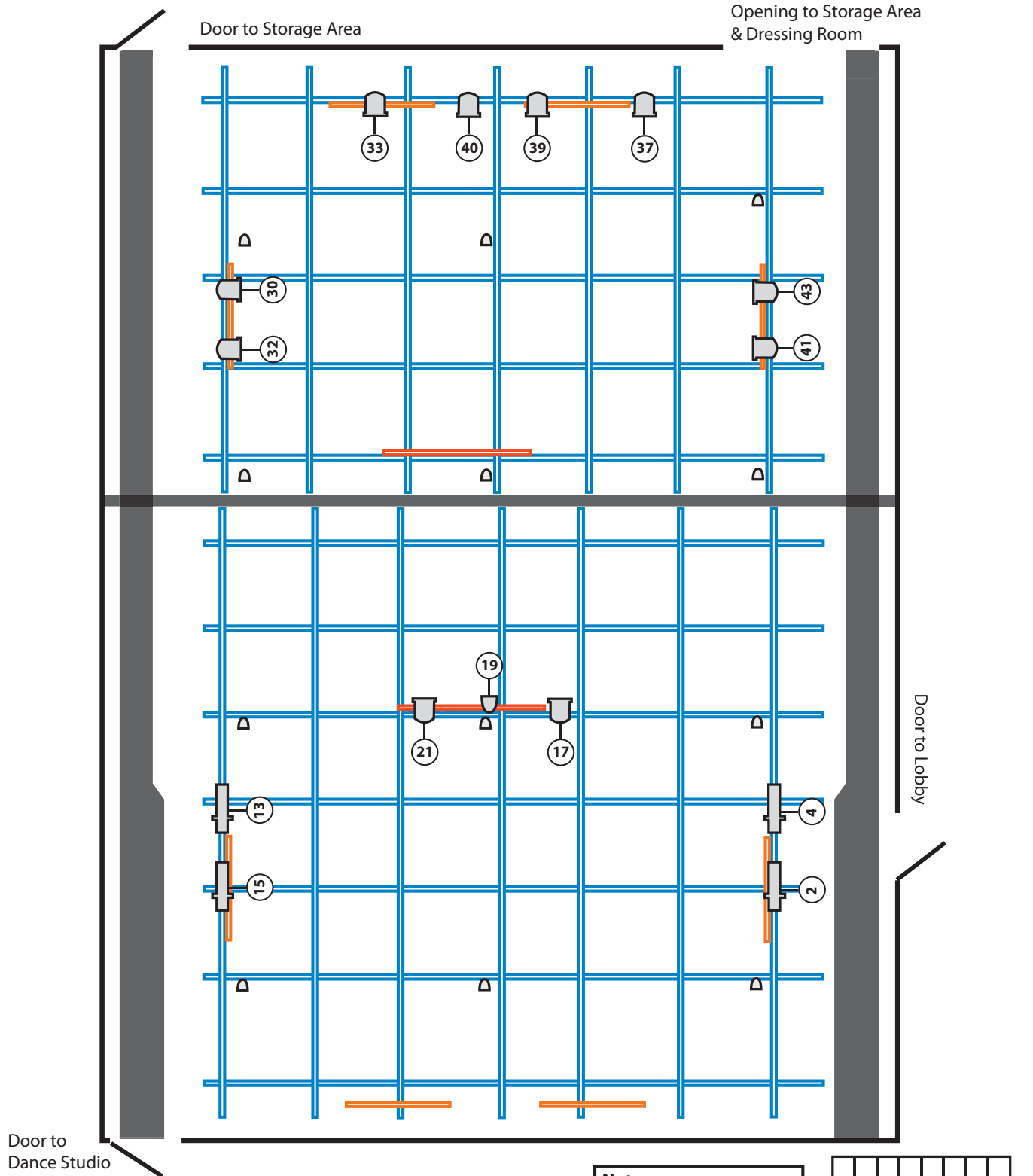

KEY

| | | | | | |
|--|--------------------|--|-----------------|--|--------------|
| | Grid Pipe | | Source 4 Zoom | | 6" Fresnel |
| | 4-Channel Smartbar | | Source 4 Parnel | | House Light* |
| | 6-Channel Smartbar | | 1 | | Channel # |

Notes

*House lights are assigned to dimmer addresses 240-245 & 300-305 and need to be patched into channels

